

Tees - 三通 - Ti - T-Stücke

UP. 03. SF

- 90° Tee
- Female solvent socket
- Metric series

- 90°三通
- 平口连接
- 公制系列

- Ti 90°
- Incollaggio femmina
- Serie metrica

- T-Stück 90°
- 3 Klebemuffen
- Metrische Serie

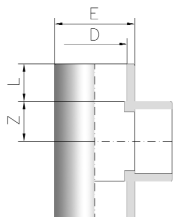

D	CODE	REF.	DN	PN	L	Z	E
16	16308	05 03 016	10	16	14	9	22
20	01780	05 03 020 ^{1 2}	15	16	16	11	27
25	01781	05 03 025 ^{1 2}	20	16	19	14	33
32	01782	05 03 032 ^{1 2}	25	16	22	17	41
40	01783	05 03 040 ^{1 2}	32	16	26	21	50
50	01784	05 03 050 ^{1 2}	40	16	31	26	63
63	01785	05 03 063 ^{1 2}	50	16	38	33	78
75	01786	05 03 075 ²	65	16	44	39	90
90	01787	05 03 090 ²	80	16	51	46	108
110	01788	05 03 110	100	16	61	56	131
125	01789	05 03 125	110	16	69	64	148
140	01790	05 03 140	125	16	76	71	164
160	01791	05 03 160	150	10	86	81	186
200	01792	05 03 200	175	10	106	101	228
225	01793	05 03 225	200	10	119	114	255
250	01794	05 03 250	225	10	131	126	284
315	01795	05 03 315	300	10	164	159	356
400	05328	05 03 400 *	325	4	206	280	432

UP. 03. SFT

- 90° Tee
- Female solvent socket & BSP female thread
- Metric series

- 90°三通
- 平口连接 & BSP内螺纹
- 公制系列

- Ti 90°
- Incollaggio femmina e filetto femmina BSP
- Serie metrica

- Übergangs T-Stück 90°
- 2 Klebemuffen/Innengewinde BSP
- Metrische Serie

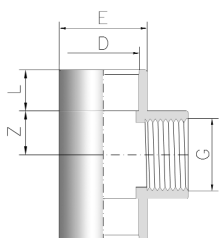

D x G	CODE	REF.	DN	PN	L	Z	E
20 x 1/2"	01796	05 03 420	15	10	16	11	28
25 x 3/4"	01797	05 03 425	20	10	19	14	34
32 x 1"	01798	05 03 432	25	10	22	17	43
40 x 1 1/4"	01799	05 03 440	32	10	26	21	54
50 x 1 1/2"	01800	05 03 450	40	10	31	26	63
63 x 2"	01801	05 03 463	50	10	38	33	78
75 x 2 1/2"	22602	05 03 475	65	10	44	39	89
90 x 3"	22603	05 03 490	80	10	51	47	106
110 x 4"	22604	05 03 510	100	10	61	57	129

UP. 03. SFTR

- 90° Reinforced tee
- Female solvent socket & BSP female thread
- Metric series

- 90°加固三通
- 平口连接 & BSP内螺纹 不锈钢加固
- 公制系列

- Ti 90° rinforzata
- Incollaggio femmina e filetto femmina BSP
- Serie metrica

- Übergangs T-Stück 90° verstärkt
- 2 Klebemuffe/Innengewinde BSP
- Metrische Serie

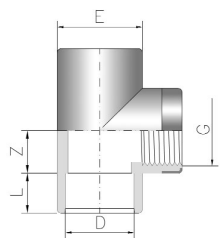

D x G	CODE	REF.	DN	PN	L	Z	E
20 x 1/2"	01808	05 03 820	15	16	16	11	28
25 x 3/4"	01809	05 03 825	20	16	19	14	34
32 x 1"	01810	05 03 832	25	16	22	17	43
40 x 1 1/4"	01811	05 03 840	32	16	26	21	54
50 x 1 1/2"	01812	05 03 850	40	16	31	26	63
63 x 2"	01813	05 03 863	50	16	38	33	78

UP. 03. FT

- 90° Tee
- BSP female thread

- 90°三通
- BSP内螺纹

- Ti 90°
- Filetto femmina BSP

- T-Stück 90°
- 3 Innengewinde BSP

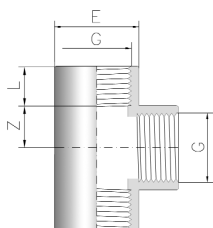

G	CODE	REF.	DN	PN	L	Z	E
1/2"	01802	05 03 620	15	10	16	11	28
3/4"	01803	05 03 625	20	10	19	14	34
1"	01804	05 03 632	25	10	22	17	43
1 1/4"	01805	05 03 640	32	10	26	21	54
1 1/2"	01806	05 03 650	40	10	31	26	63
2"	01807	05 03 663	50	10	38	33	78
2 1/2"	22593	05 03 675	65	10	30	53	89
3"	22594	05 03 690	80	10	34	65	106
4"	22595	05 03 710	100	10	40	79	129